

## Technical Specifications (event/reversed setup)

### Address information

De Maaspoort Theater & Events

Mail/public entrance: Oude Markt 30, 5911 HH Venlo, Netherlands.

Loading Bay: Peperstraat 31, 5911 HA Venlo, Netherlands.

Artist entrance: Peperstraat 27, 5911 HA Venlo, Netherlands.

### Contact information

T: +31(0)77 320 72 22

E: [info@maaspoort.nl](mailto:info@maaspoort.nl)

W: [www.maaspoort.nl](http://www.maaspoort.nl)

### Technical information

W: <http://www.maaspoort.nl/informatie/theatertechniek/techniek>

### Technical information contact

Tom Janssen

T: +31(0)6 270 549 40

E: [t.janssen@maaspoort.nl](mailto:t.janssen@maaspoort.nl)

### Note

The Maaspoort is a theatre where many events and performances take place.

It is therefore not possible to make a standard technical list with the material that is permanently available.

A technical set is often put together for large-scale events by combining our equipment from the various stages.

Therefore make sure that you are always in contact with our technical department. Depending on your wishes, they will hire any additional materials required or put together a package from different stages.

### Sizes stages

Hela stage – permanent 14 x 6 (average) x 1 m

Frans Boermans stage – permanent 12 x 8 x 1 m – sidestage 8 x 4 x 1 m (stage right)

Piet Kingma stage – permanent 12 x 8 (no height-adjustable stage)

### Global Visual Hela stage (without dimensions) + impression photo

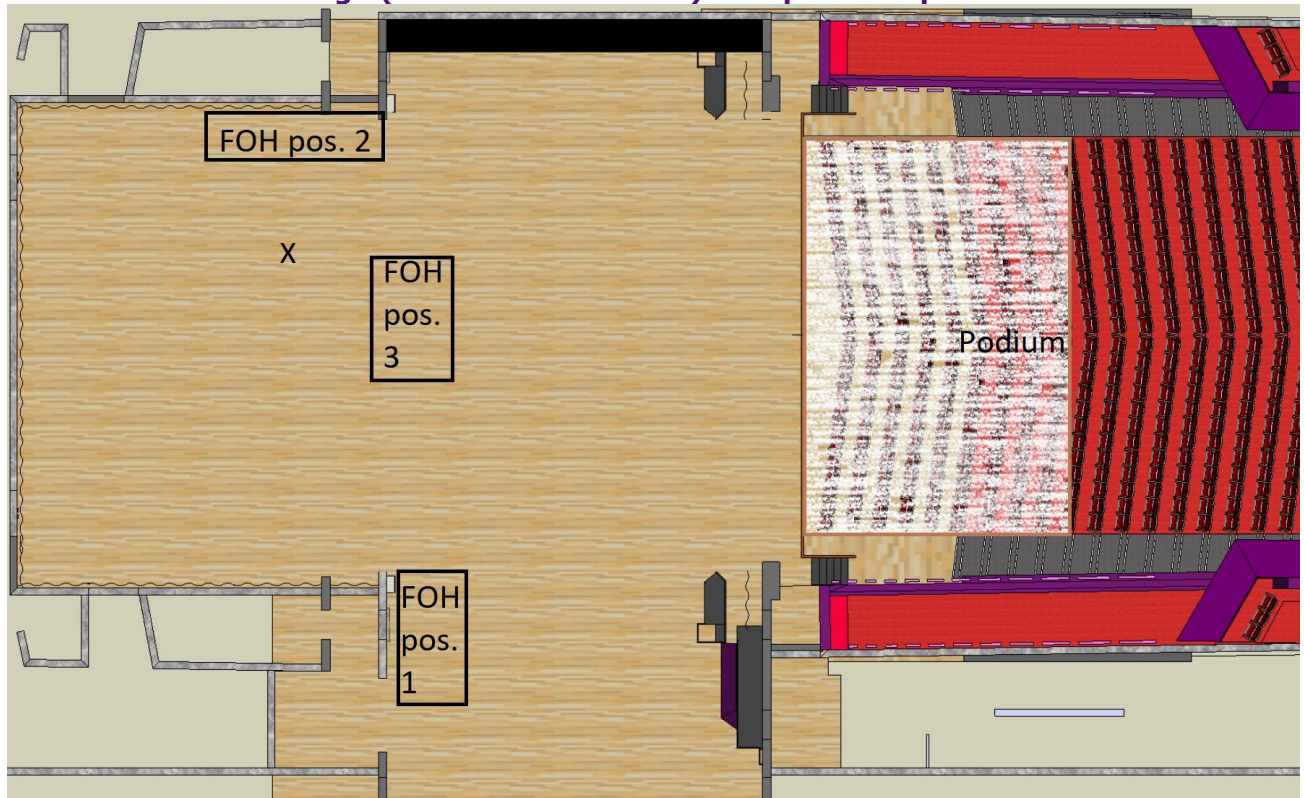

Photo was taken at position x



## Sizes Visual Hela stage

### Zaal en podium van de omgedraaide toneel opstelling

Zie pagina 2

Pagina 1  
Plattegrond  
Rabobank Venlo Zaal

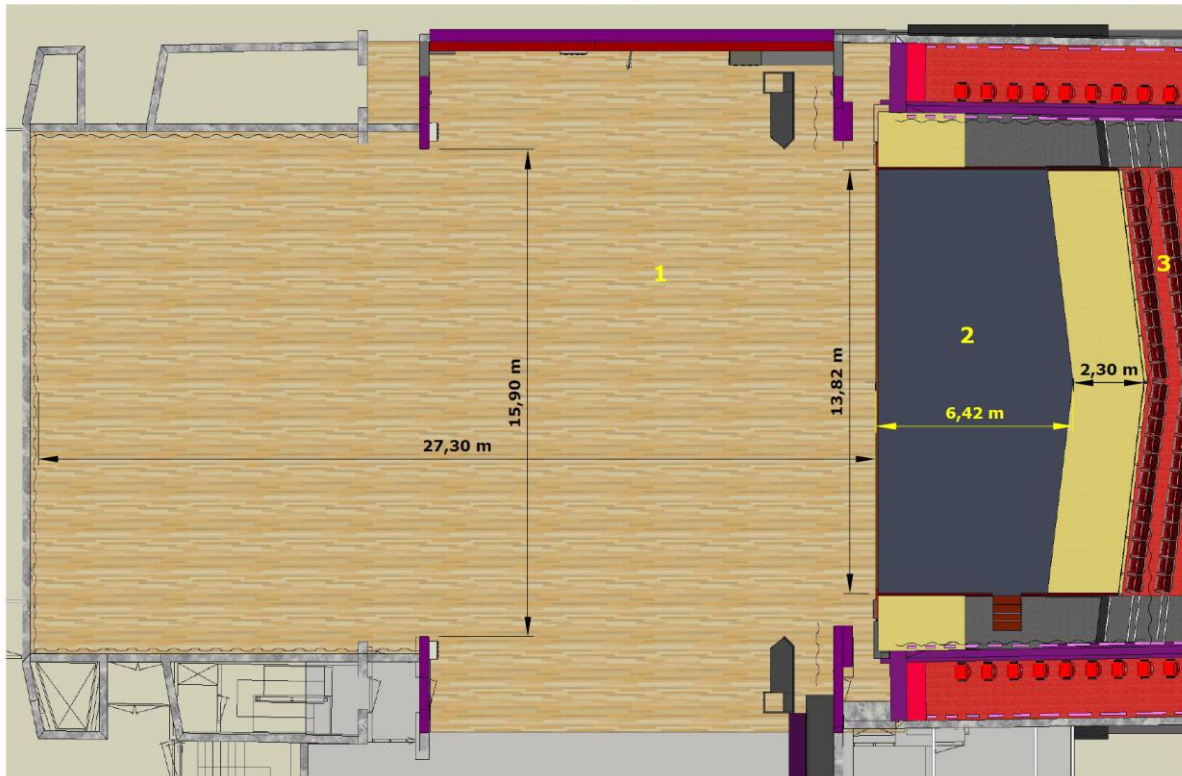

### Zaal en podium van de omgedraaide toneel opstelling

Pagina 2  
Podiumindeling  
Rabobank Venlo Zaal

Renvoel:

- |   |  |
|---|--|
| 1 = Zaalvloer (zie pagina 1)  | 9 = Optionele valbeveiliging bij pos 2.            |
| 2 = Podium hoogte variabel van 0 tot max. 100 cm.<br>Bestaande uit 2 onafhankelijke delen delen.<br>Optioneel voorzien van zwarte baletvloer. | 10 = Optionele valbeveiliging bij pos 2.           |
| 3 = Maaspoort tribune (zie pagina 1)  | 11 = Zwarte achtergrond gordijn.                   |
| 4 = Optioneel extra verhoging van 60 cm bij pos 2 op 100 cm.  | 12 = Zwarte afdekdoek zijbalkons                   |
| 5 = Optioneel zijpodium.  | 13 = Voorste trek max. belasting 500 kg. totaal.   |
| 6 = Optioneel zijpodium.  | 14 = Achterste trek max. belasting 500 kg. totaal. |
| 7 = Artisten trap.  | 15 = Maaspoort toneel gordijnen.                   |
| 8 = Verplichte valbeveiliging bij pos 4.  |  |

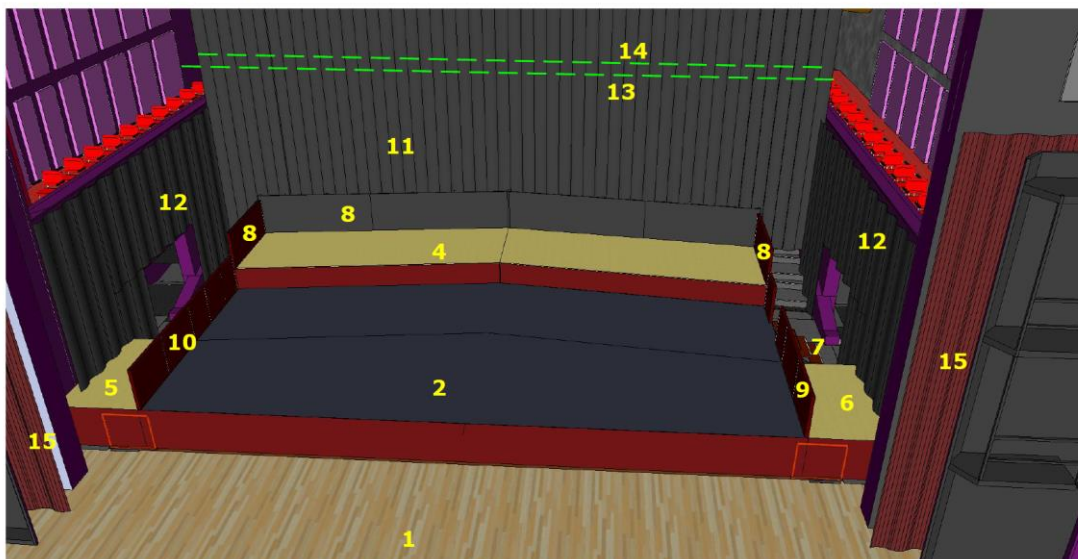

## Sizes Visual Frans Boermans stage

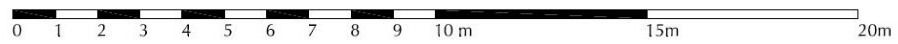
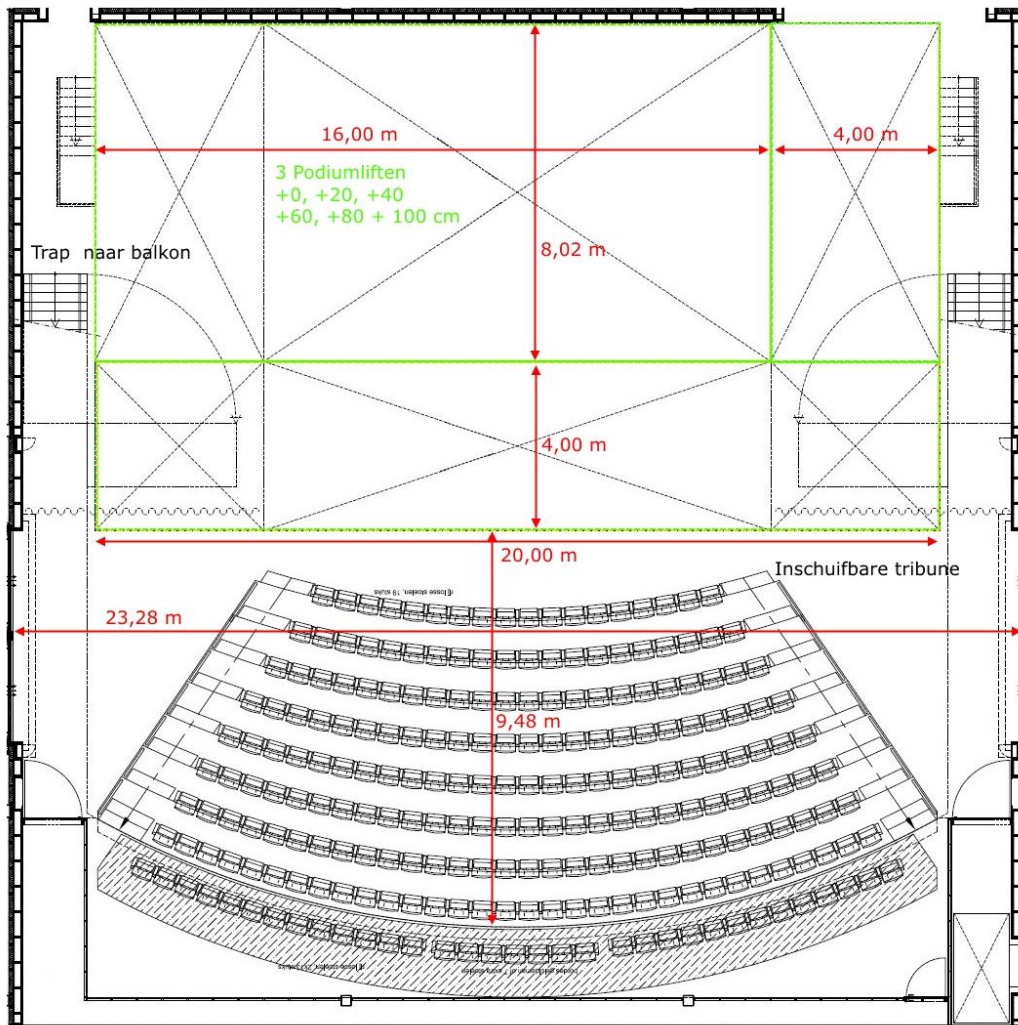

## Rigging

Have a look for the up to date Fly-bar list (trekkenlijst).

Hela stage:

Meters Upstage	Max load	Note
-13,53 → -3,95	500 KG	44 different fly-bars
Sluier.1: -1,3		
Sluier.2: -2,3	500 KG	
Prosc.: -0,5	300 KG (Equally divided)	No hanging point in the middle
Line Array:	250 KG. 2 pick point each.	Total of 4 motors.
Auditorium 2: 7,8	300 KG (Equally divided)	No hanging point in the middle
Auditorium 1: 8,75	300 KG (Equally divided)	No hanging point in the middle

Frans Boermans stage:

Meters Upstage	Max load	Note
-8,61 → 0,59	500 KG	7 different fly-bars
Fly-bars 11: -0,19	500 KG	
Fly-bars 12: 0,21	500 KG	
Fly-bars 13: 0,61	500 KG	
Fly-bars 14: 1,26	500 KG	
Fly-bars 15: 1,66	500 KG	
Fly-bars 16: 2,06	500 KG	
Fly-bars 17: 2,46	500 KG	
Fly-bars 18: 2,86	500 KG	
Fly-bars 19: 3,56	500 KG	
Fly-bars 20: 3,96	500 KG	
Fly-bars 21: 4,36	500 KG	
Fly-bars 22: 4,76	500 KG	
Fly-bars 23: 5,16	500 KG	
Fly-bars 24: 5,56	500 KG	
Fly-bars 25: 5,96	500 KG	Cyclorama (ETC LED7color)
Fly-bars 26: 6,63	500 KG	
Fly-bars 27: 7,03	500 KG	
Fly-bars 28: 7,43	500 KG	Don't use. Black backdrop
Fly-bars 29: 7,83	500 KG	Don't use. White screen

## Audio

### Hela stage

Quantity	Description	Type	Brand
	<b>PA</b>		
2	Subs	600-HP	Meyer
9 Cabinets	Line array (L+R)	M'elodie	Meyer
2	Delay	UPQ 1P	Meyer
2	Infill	UPQ 1P	Meyer

### Frans Boermans stage

Quantity	Description	Type	Brand
	<b>PA</b>		
2	Subs	1100-HP	Meyer
5 Cabinets	Line array (L+R)	M'elodie	Meyer
2 Cabinets	Line Array Balcony (L+R)	M'elodie	Meyer
2	Centre	UPQ 1P	Meyer
2	Infill (optional)	UPQ 1P	Meyer

### Audio equipment for all the stages

Quantity	Description	Type	Brand
8	Monitor	LE200	Martin
8	Monitor	SX300	EV
2	Amp. (2 way)		Yamaha
2	Amp. (4 way)	T604	Powersoft
1	Desk	SQ 5	Allen & Heath
1	Desk	D-Live 3500 DM 32	Allen & Heath
1	Desk	D-Live 5000 DM 48	Allen & Heath

Quantity	Mic's/DI's Description	Type	Brand
8	Headset		DPA
12	DI	AR-133	BSS Audio
2	DI	DIB-100	IMQ Stage Line
1	Base drum	D112	AKG
2	Overhead	C451EB	AKG
3	Tom/Snare	D40	AKG
3	Crown	PCC160	AKG
4	Overhead	CK5	AKG
8	Overhead	KM 184	Neumann
2	Vocal	KMS 105	Neumann
1		Black Fire 521	Sennheiser
1		Black Fire 531	Sennheiser
10	Tom/Snare	E604	Sennheiser
4	Vocal	E865 S	Sennheiser
2	Overhead	ME80	Sennheiser
4	Overhead	MKH416 P48	Sennheiser
6	Tablemic.	MZH 3040	Sennheiser
2	Base drum	Beta 52A	Shure
2	Snare	Beta 56A	Shure
5	Vocal	Beta 58A	Shure
5	Vocal	SM 58	Shure
6	Clip on	Beta 98H	Shure
8		SM 57	Shure
1		Beta 57A	Shure
2	Reverclip	WL184	Shure

**Wireless**

<b>Quantity</b>	<b>Description</b>	<b>Type</b>	<b>Brand</b>
8	Receiver	QLXD4	Shure
6	Beltpack	QLXD1	Shure
8	Handheld	QLXD2 Beta 87A	Shure
2	In-ear Transmitter	PSM300	Shure
4	In-ear Beltpack receiver	P3RA	Shure

<b>Quantity</b>	<b>Stands Description</b>	<b>Type</b>	<b>Brand</b>
6	Low + Boom		K&M
20	High + boom		K&M
7	High		K&M
3	Round base		K&M

<b>Quantity</b>	<b>DJ Gear Description</b>	<b>Type</b>	<b>Brand</b>
1	DJ Mixer	DJM-900 Nexus	Pioneer
2	CD Player	CDJ-2000 Nexus	Pioneer

<b>Light Quantity</b>	<b>Description</b>	<b>Type</b>	<b>Brand</b>
<b>Controller</b>			
2	Control desk	ETC GIO	ETC
1	Control desk	ETC ION XE	ETC
1	Faderwing 20 motorized	/	ETC
2	Dimmer rack 24 CH	Alex M 2,5 KVA	ETC
<b>Conventional</b>			
20	2 KW Fresnel		
12	1 KW zoom profile		
12	1 KW Fresnel		
2	ACL Set		
6	Blinder (DWE)		
	Par 64		
20	6-bar (Par 64)		
<b>Led</b>			
42	ETC Led Par	D40 Desire Lustr+	ETC
10	3-Bar ETC Led Par	D40 Desire Lustr+	ETC
24	Source Four profielspot	S4 LED lstr+ (1)	ETC
<b>Movinghead</b>			
24	Beam movinghead	LEDBeamer 150 FW RGBA	Robe
12	Spot movinghead	T1 Profile	Robe
<b>Smoke/Haze</b>			
4	Hazer	K1 (water based)	Swefog
1	Smoke machine	Antari Z-1500	Antari
1	Smoke machine	Antari W-530D	Antari